

ORDER

SECTION 35, THE MINING ACT, R.S.O. 1990

ORDER NO. O-L-45/16

The MINING RIGHTS of the area outlined in red on the attached sketch, in the Township of Walker, Larder Lake Mining Division, containing 128 hectares, more or less, are hereby REOPENED to prospecting, staking out, sale or lease.

This area was originally withdrawn by Order W-L-21/00, while the Ministry determined the status of the land.

This order comes into effect on Tuesday, September 6, 2016 at 08:00:01 a.m. standard time.

Original Signed by Tony Scarr

Tony Scarr, Provincial Mining Recorder
Mining Lands Section
Mines and Minerals Division

Copies:

Senior Manager, Mining Lands Section, MNDM, Sudbury

Provincial Mining Recorder, MNDM, Sudbury

Provincial Lands Specialist - CLR

O-L-45/16



Base Features

- Tower
- Work Camp
- Mining Divisions_MAR2_2016
- Utility Site
- MNDM Administrative Boundaries
- Lot Fabric Improved
- Utility Line - Hydro Line**
- Transmission Line
- Pipeline
- Road Segment**
- Other Existing Roads
- Primary
- Highway
- Trail Segment
- Railway Segment
- Airports**
- Airports
- Airport Airstrip
- Airport Official

Mining Lands Features

- Dispositions Symbols**
- Freehold Patent, S+M
- Freehold Patent, SRO
- Freehold Patent, MRO
- Leasehold Patent, S+M
- Leasehold Patent, SRO
- Leasehold Patent, MRO
- Licence of Occupation, S+M
- Licence of Occupation, SRO
- Licence of Occupation, MRO
- Licence of Occupation, not specified
- Tower
- Camp
- Unknown
- Order in Council
- Land Use Permit
- WPLA
- Mining Divisions_MAR2_2016
- MNDM Alienations**
- Active, Withdrawal
- Active, Notice
- Cancelled, Withdrawal
- Cancelled, Notice
- MNDM Mining Claims**
- Active
- Cancelled
- Pending
- MNDM Dispositions**
- Active
- Cancelled

Federal Protected Area

- Federal Protected Area
- Federal Land Other
- Indian Reserve

Waterbodies

- River / Stream
- Waterbody

Provincial Park Regulated

- Provincial Park Regulated
- Conservation Reserve Regulated

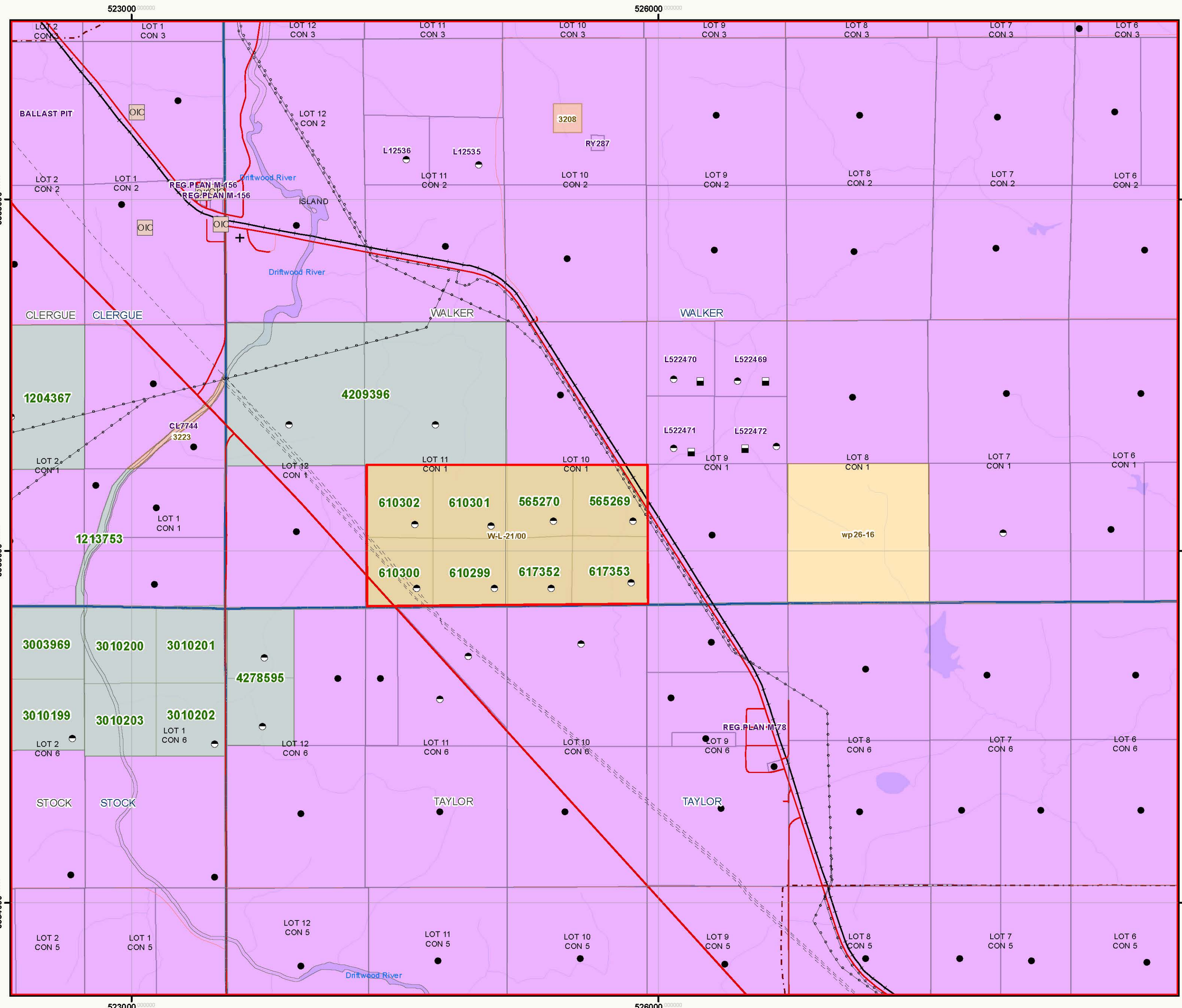

1:16,746

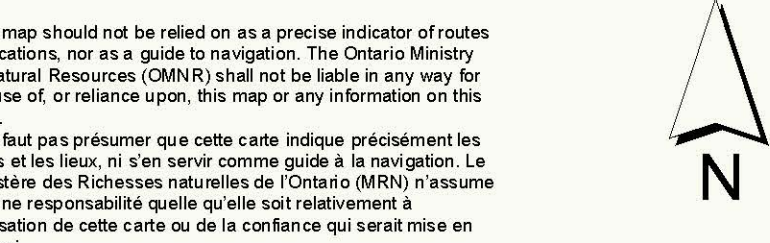

This map should not be relied on as a precise indicator of routes or locations, nor as a guide to navigation. The Ontario Ministry of Natural Resources (OMNR) shall not be liable in any way for the use of, or reliance upon, this map or any information on this map.
 Il ne faut pas présumer que cette carte indique précisément les voies et les lieux, ni s'en servir comme guide à la navigation. Le ministère des Richesses naturelles de l'Ontario (MRN) n'assume aucune responsabilité quelle qu'elle soit relativement à l'utilisation de cette carte ou de la confiance qui serait mise en celle-ci.