

**ORDER**

**SECTION 35, THE MINING ACT, R.S.O. 1990**

**ORDER NO. O-L-58/24**

The MINING RIGHTS of the area outlined in red on the attached sketch, situated in Melba Township, Larder Lake Mining Division, containing 40.92 hectares more or less, were withdrawn from prospecting, mining claim registration, sale and lease by Order W-L-75/07 while the Ministry determined the status of the lands.

Withdrawal Order W-L-75/07 is hereby revoked and the lands are REOPENED for prospecting, mining claim registration, sale and lease, unless the lands are otherwise not open for these activities under any other provision of the Mining Act.

This order comes into effect upon signing.

Date: April 25, 2024

Time: 11:16 am

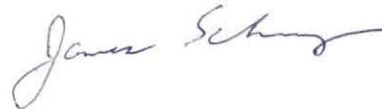

---

James Schwyer, Provincial Mining Recorder  
Mining Lands Section  
Mines and Minerals Division

**Copies:**

Senior Manager, Mining Lands Section, MINES, Sudbury  
Provincial Mining Recorder, MINES, Sudbury  
Provincial Lands Specialist – CLR



## Larder Lake Mining Division

1:9,660

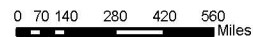
Ontario 

© King's Printer for Ontario, 2023

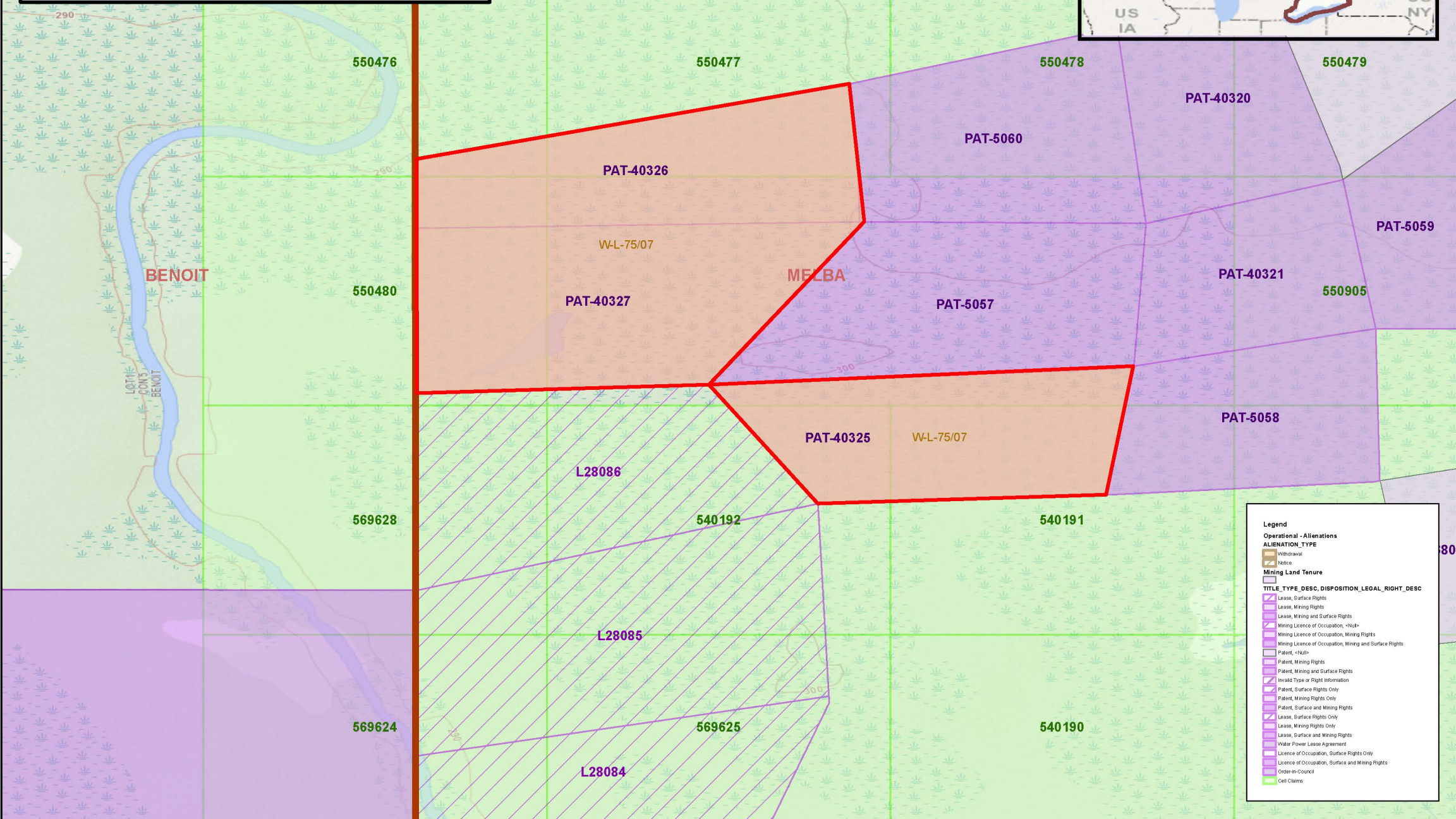

**Legend**

Operational - Alienations

**ALIENATION\_TYPE**

 Withdrawal

**Notice**  
**Mining Land Tenure**

**Mining Land Tenure**

**TITLE\_TYPE\_DESC, D**

 Lease, Surface Right

☐ Lease, Mining Rights

 Mining Licence of Occupancy

☐ Mining Licence of Occupancy

 Mining Licence of Occupancy

Patent, <Null>
----------------

☐ Patent, Mining Rights☒ Invalid Type or Right

Patent, Surface Right

☐ Patent, Mining Rights

Patent, Surface and I

☐ Lease, Surface Right

☐ Lease, Mining Rights

☐ Lease, Surface and 3

Water Power Lease A

☐ Licence of Occupation

**1. Licence of Occupation**

 Order-in-Council

**Cell Claims**

\_\_\_\_\_