

ORDER

SECTION 35, THE MINING ACT, R.S.O. 1990

ORDER NO. O-P-62/18

The MINING RIGHTS of the area outlined in red on the attached sketch, situated in the Township of Hoyle (G-3987), Porcupine Mining Division, are hereby REOPENED to prospecting, registering, sale or lease.

This area was originally withdrawn by Order W-P-42/18.

This order comes into effect upon signing.

Date: July 24, 2018

Originally signed by Tabitha Brown

Time: 3:15 pm

Patrick Brown, A/Provincial Mining Recorder
Mining Lands Section
Mines and Minerals Division

Copies:
Senior Manager, Mining Lands Section, MNDM, Sudbury
Provincial Mining Recorder, MNDM, Sudbury
Provincial Lands Specialist - CLR

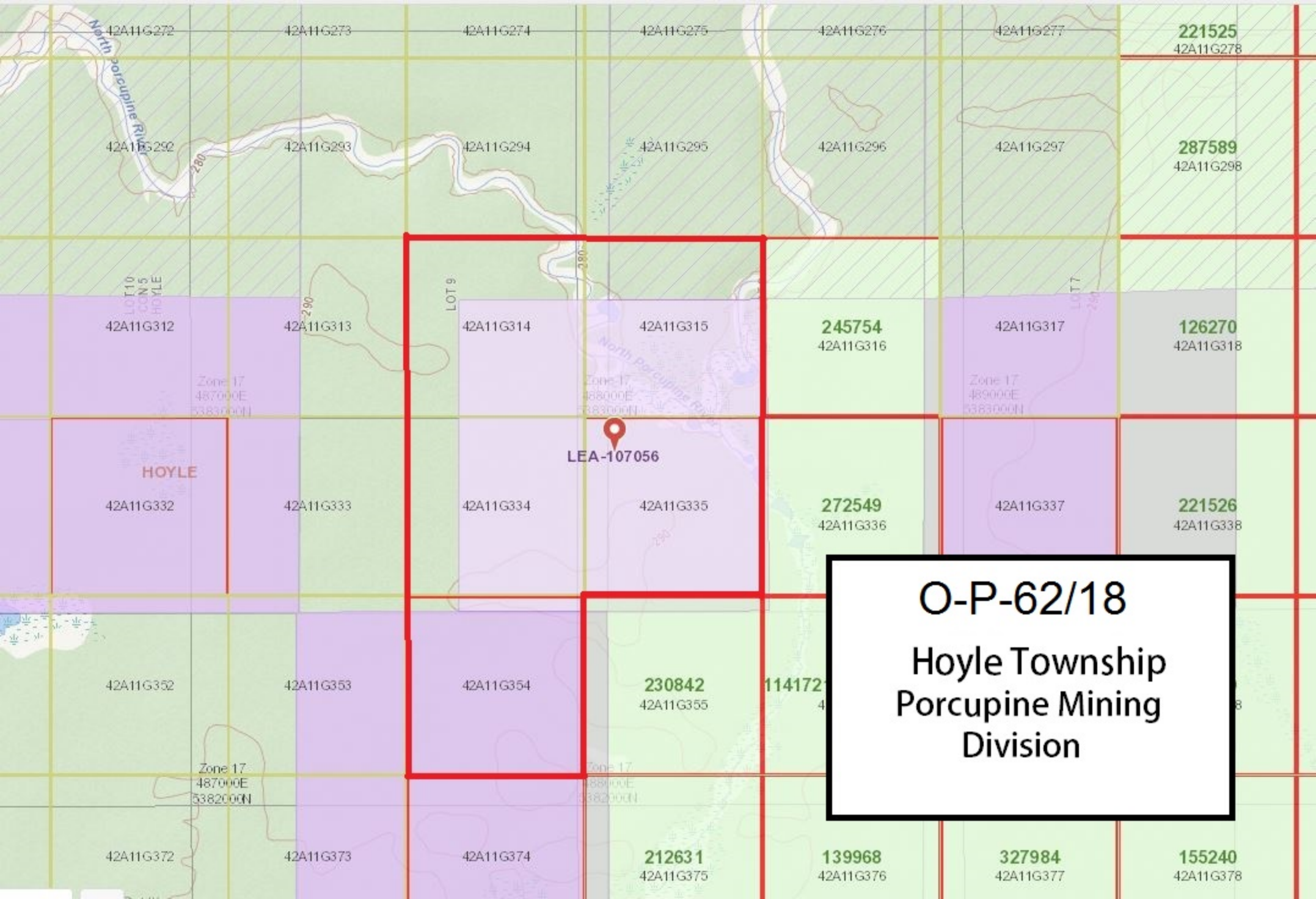

221525
42A11G278

287589
42A11G298

245754
42A11G316

126270
42A11G318

LEA-107056

272549
42A11G336

221526
42A11G338

O-P-62/18
Hoyle Township
Porcupine Mining
Division

230842
42A11G355

114172
42A11G356

212631
42A11G375

139968
42A11G376

327984
42A11G377

155240
42A11G378