

ORDER

SECTION 35, THE MINING ACT, R.S.O. 1990

ORDER NO. O-S-39/18

The SURFACE and MINING RIGHTS of the areas identified in red on the attached sketches, situated in the Townships of Capreol (G-4019), Norman (G-4092), Trill (G-4115), Broder (G-4016), McKim (M-1013), Waters (G-4120) and MacLennan (G-4078), Sudbury Mining Division, are hereby REOPENED to prospecting, staking out, sale or lease.

These areas were originally withdrawn by Order W-S-31/02.

This order comes into effect upon signing.

Date: April 11, 2018

Originally signed by Patrick Brown

Time: 3:28 pm

Patrick Brown, A/Provincial Mining Recorder
Mining Lands Section
Mines and Minerals Division

Copies:
Senior Manager, Mining Lands Section, MNDM, Sudbury
Provincial Mining Recorder, MNDM, Sudbury
Provincial Lands Specialist - CLR

O-S-39/18
Capreol Township
Sudbury Mining Division

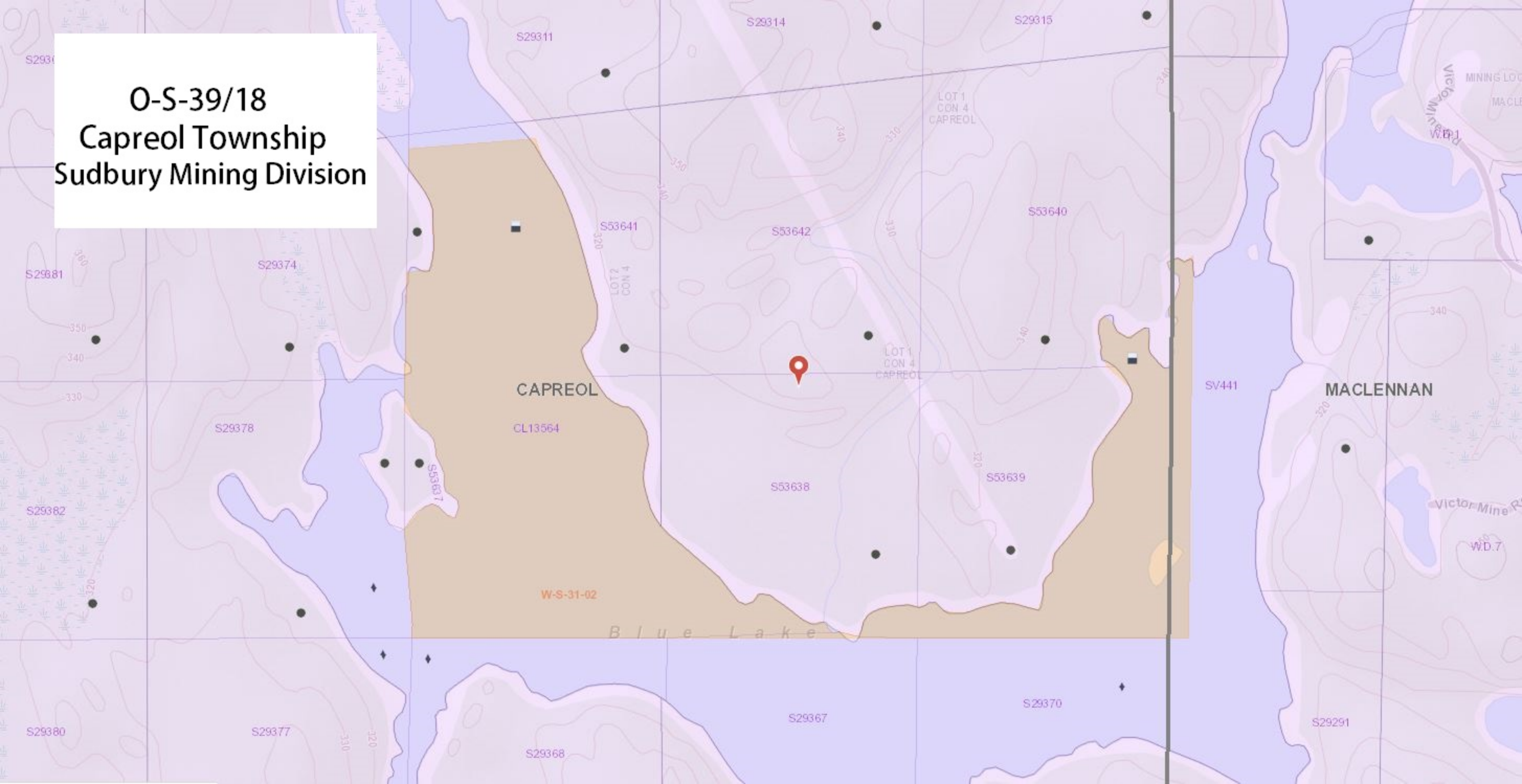

O-S-39/18
Capreol Township
Sudbury Mining Division



O-S-39/18
Norman Township
Sudbury Mining Division

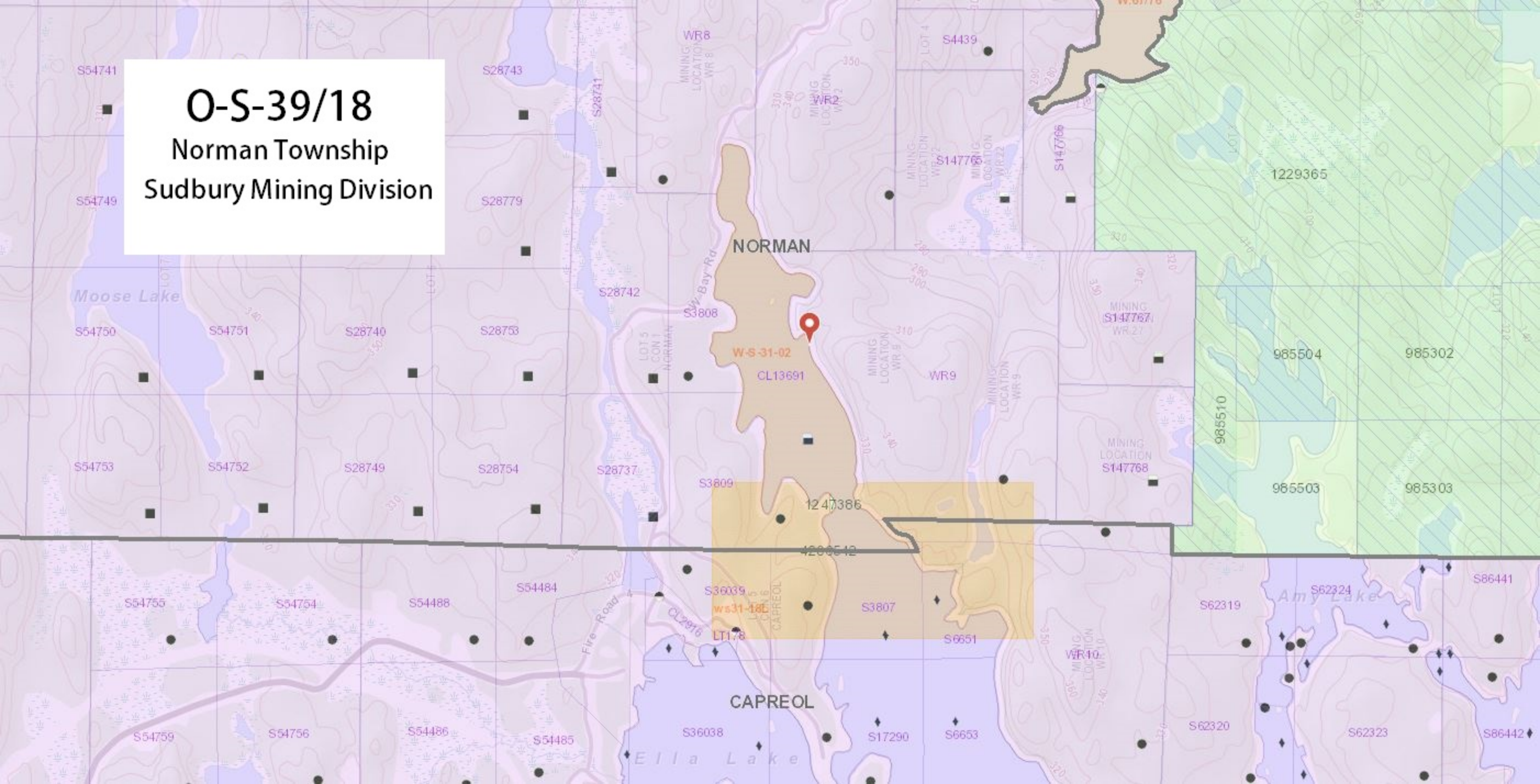

O-S-39/18
Trill Township
Sudbury Mining Division

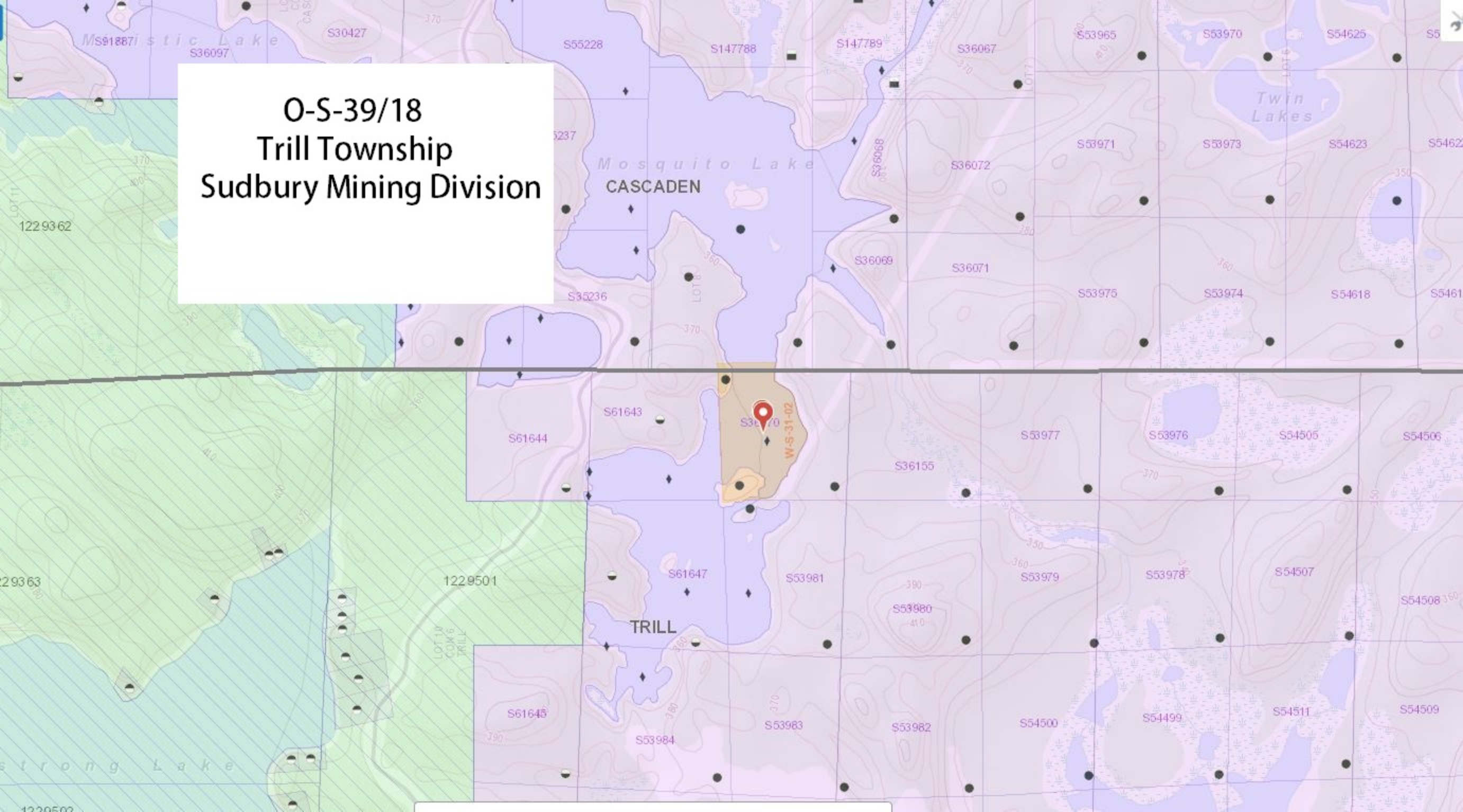

O-S-39/18
Re-opening of
W-S-31/02

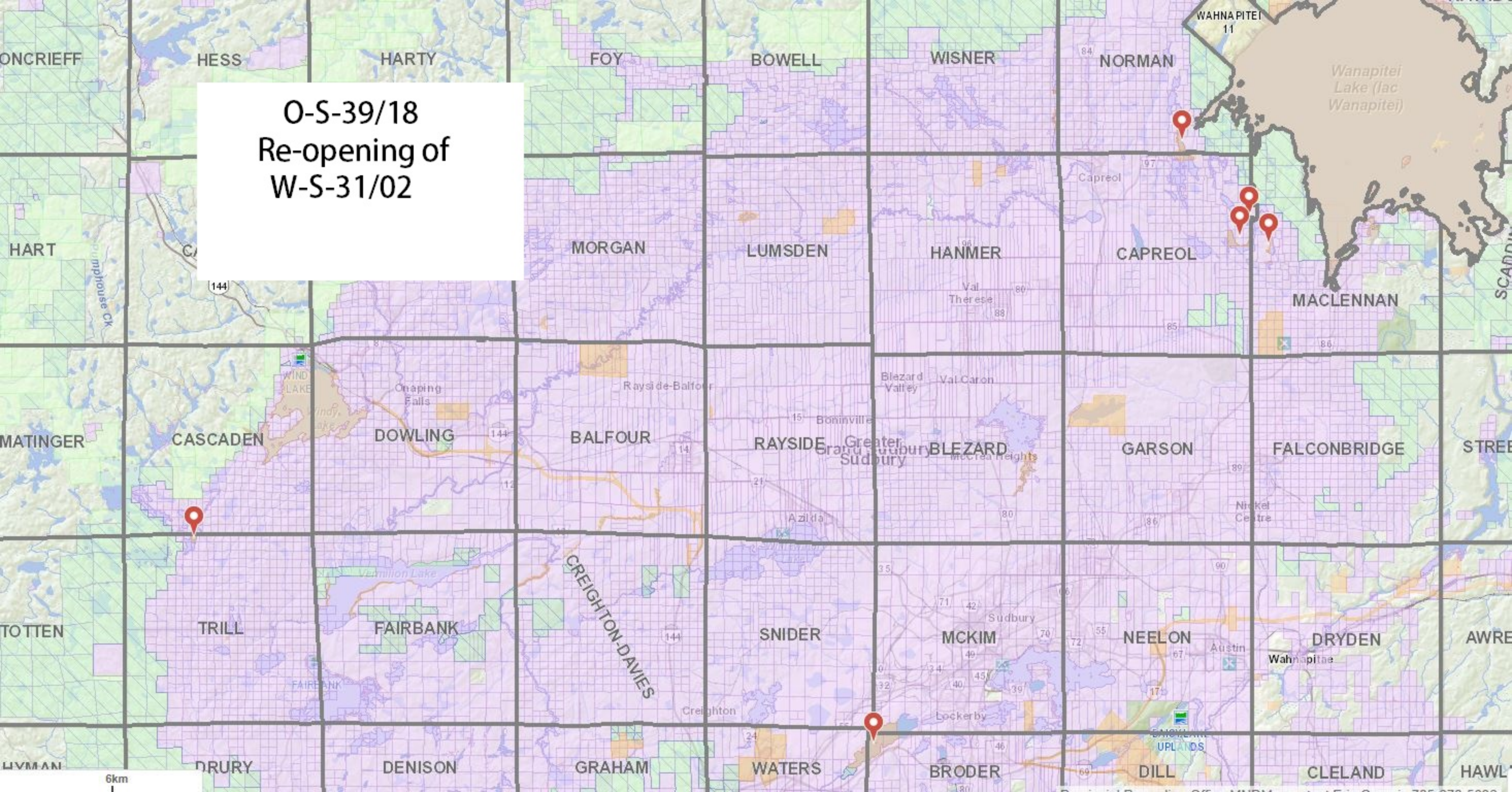

O-S-39/18
MacLennan Township
Sudbury Mining Division

