

ORDER**SECTION 35, THE MINING ACT, R.S.O. 1990****ORDER NO. O-TB-41/16**

The SURFACE and MINING RIGHTS of the area outlined in red on the attached sketch, in Pardee (G-0681) Township, Thunder Bay Mining Division, containing 48 hectares, more or less, are hereby REOPENED to prospecting, staking out, sale or lease.

This area was originally withdrawn by Order W-TB-37/16, while the Ministry determined the status of the land.

This order comes into effect upon signing.

Date: July 25/16

Time: 2:30 P.M.

Original Signed by Brian Laine

For Tony Scarr, Provincial Mining Recorder
Mining Lands Section
Mines and Minerals Division

Copies:
Senior Manager, Mining Lands Section, MNDM, Sudbury
Provincial Mining Recorder, MNDM, Sudbury
Provincial Lands Specialist - CLR

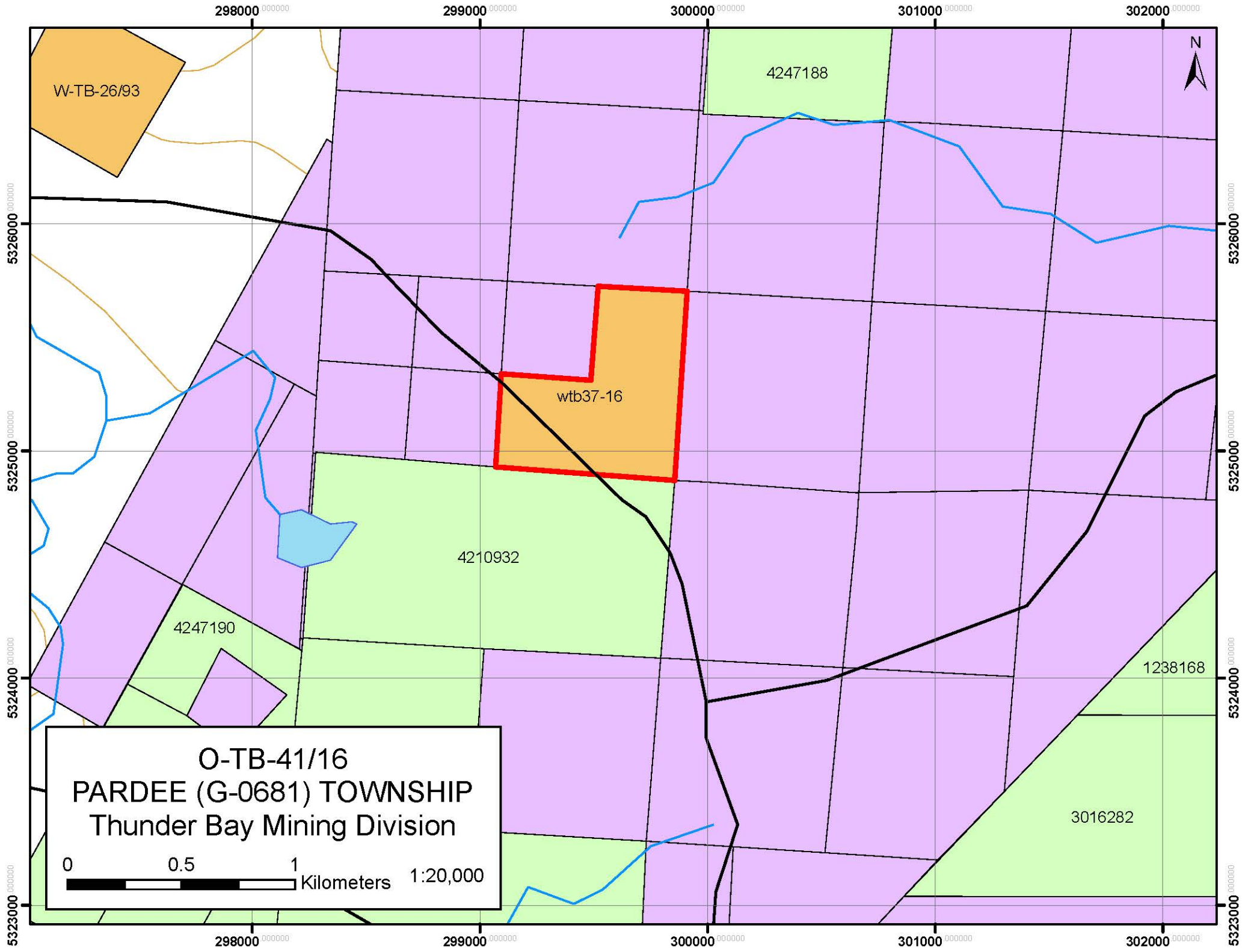

O-TB-41/16
PARDEE (G-0681) TOWNSHIP
Thunder Bay Mining Division

0 0.5 1 Kilometers 1:20,000