

ORDER**SECTION 35, THE MINING ACT, R.S.O. 1990****ORDER NO. O-TB-52/16**

The SURFACE and MINING RIGHTS of the area outlined in red on the attached sketch, in the Pickerel Lake Area (G-0547) , Thunder Bay Mining Division, containing 16 hectares, more or less, are hereby REOPENED to prospecting, staking out, sale or lease.

This area was originally withdrawn by Order W-TB-61/16, while the Ministry determined the status of the land.

This order comes into effect upon signing.

Date: DEC 01 2016

Time: 4:00 p.m.

ORIGINAL SIGNED BY TONY SCARR

Tony Scarr, Provincial Mining Recorder
Mining Lands Section
Mines and Minerals Division

Copies:

Senior Manager, Mining Lands Section, MNDM, Sudbury

Provincial Mining Recorder, MNDM, Sudbury

Provincial Lands Specialist - CLR

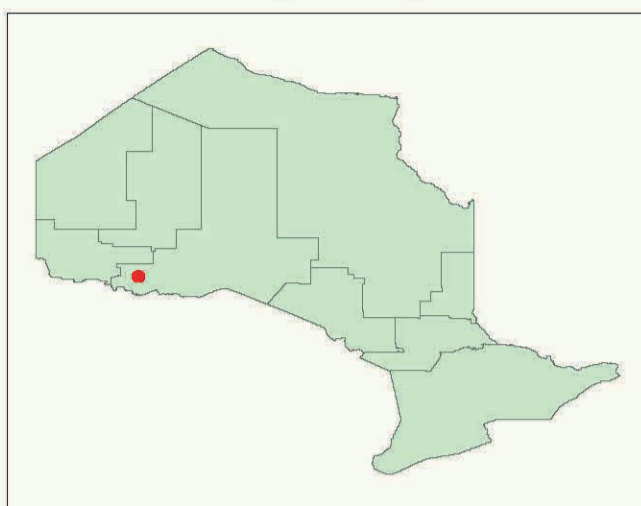

Base Features

- Area to Reopen
- + Tower
- △ Work Camp
- ⚡ Utility Site
- MNDM Administrative Boundaries
- Lot Fabric Improved

Utility Line - Hydro Line

- Transmission Line
- Ligne de transmission
- Pipeline
- Pipeline

Road Segment

- Other Existing Roads
- Autres routes actuelles
- Primary
- Route principale
- Highway
- Autoroute
- Trail Segment
- Railway Segment

Airports

- Airports
- Airport Airstrip
- Airport Official

Federal Protected Area

- Federal Protected Area
- Federal Land Other
- Indian Reserve

Waterbodies

- River / Stream
- Waterbody

Provincial Park Regulated

- Provincial Park Regulated
- Conservation Reserve Regulated

Mining Lands Features

Dispositions Symbols

- Freehold Patent, S+M
- Freehold Patent, SRO
- Freehold Patent, MRO
- Leasehold Patent, S+M
- Leasehold Patent, SRO
- Leasehold Patent, MRO
- ◆ Licence of Occupation, S+M
- ◆ Licence of Occupation, SRO
- ◆ Licence of Occupation, MRO
- ◆ Licence of Occupation, not specified
- + Tower
- ⚡ Camp
- ? Unknown

- OIC Order in Council
- LUP Land Use Permit
- WPLA WPLA

MNDM Alienations

- Active, Withdrawal
- Active, Notice
- Cancelled, Withdrawal
- Cancelled, Notice

MNDM Mining Claims

- Active
- Cancelled
- Pending

MNDM Dispositions

- Active
- Cancelled

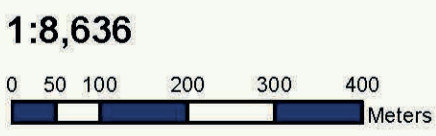
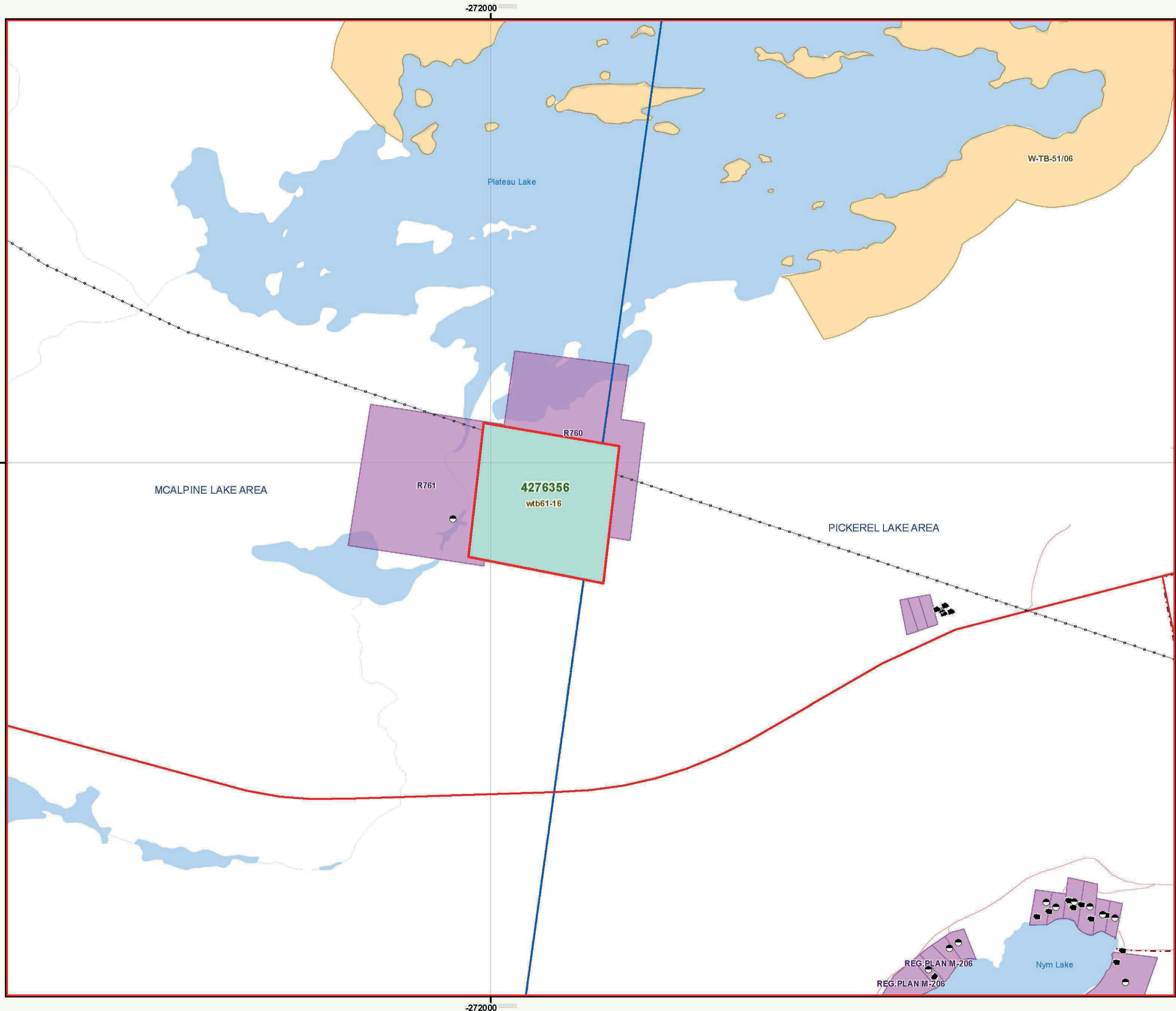

This map should not be relied on as a precise indicator of routes or locations, nor as a guide to navigation. The Ontario Ministry of Natural Resources (OMNR) shall not be liable in any way for the use of, or reliance upon, this map or any information on this map.
 Il ne faut pas présumer que cette carte indique précisément les voies et les lieux, ni s'en servir comme guide à la navigation. Le ministère des Richesses naturelles de l'Ontario (MRN) n'assume aucune responsabilité quelle qu'elle soit relativement à l'utilisation de cette carte ou de la confiance qui serait mise en celle-ci.