

**ORDER****SECTION 35, THE MINING ACT, R.S.O. 1990****ORDER NO. W-L-38/16**

The SURFACE RIGHTS and MINING RIGHTS of the areas outlined in red on the attached sketch, being cancelled unpatented mining claims L 4211811, L 4211813 and L 4217461 situated in McVittie Township (G-3163), in the Larder Lake Mining Division, containing 48 hectares more or less, are hereby WITHDRAWN from prospecting, staking out, sale or lease.

These areas are WITHDRAWN while the Ministry determines the status of the lands.

Saving, excepting and reserving hereto and herefrom, all other lands patented, sold, leased or otherwise alienated by the Crown at the date of this Order.

Any alienated lands lying within the limits of these withdrawn areas that revert to the Crown subsequent to the date of this Order will automatically be considered to be withdrawn as part of this Order.

This order comes into effect upon signing.

Date: June 15, 2016

Time: 12:37pm.

ORIGINAL SIGNED BY SOPHIE FORTIN  
FOR Tony Scarr, Provincial Mining Recorder  
Mining Lands Section  
Mines and Minerals Division

Copies:

Senior Manager, Mining Lands Section, MNDM, Sudbury

Provincial Mining Recorder, MNDM, Sudbury

Provincial Lands Specialist – CLR





**Base Features**

- W-L-38-16
- Tower
- Work Camp
- Utility Site
- MNDM Administrative Boundaries
- Lot Fabric Improved
- Municipal Boundary - Single Tier

**Utility Line - Hydro Line**

- Transmission Line
- Ligne de transmission
- Pipeline
- Pipeline

**Road Segment**

- Other Existing Roads
- Autres routes actuelles
- Primary
- Route principale
- Highway
- Autoroute
- Trail Segment
- Railway Segment

**Airports**

- Airports
- Airport Airstrip
- Airport Official

**Federal Protected Area**

- Federal Protected Area
- Federal Land Other
- Indian Reserve

**Waterbodies**

- River / Stream
- Waterbody

**Provincial Park Regulated**

- Provincial Park Regulated
- Conservation Reserve Regulated

**Mining Lands Features**

**Dispositions Symbols**

- Freehold Patent, S+M
- Freehold Patent, SRO
- Freehold Patent, MRO
- Leasehold Patent, S+M
- Leasehold Patent, SRO
- Leasehold Patent, MRO
- Licence of Occupation, S+M
- Licence of Occupation, SRO
- Licence of Occupation, MRO
- Licence of Occupation, not specified
- Tower
- Camp
- Unknown

**Order in Council**

- OIC

**Land Use Permit**

- LUP

**WPLA**

- WPLA

**MNDM Alienations**

- Active, Withdrawal
- Active, Notice
- Cancelled, Withdrawal
- Cancelled, Notice

**MNDM Mining Claims**

- Active
- Cancelled
- Pending

**MNDM Dispositions**

- Active
- Cancelled

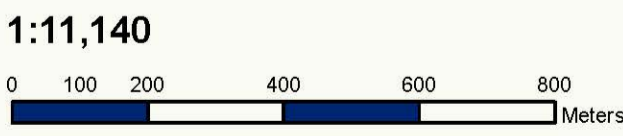
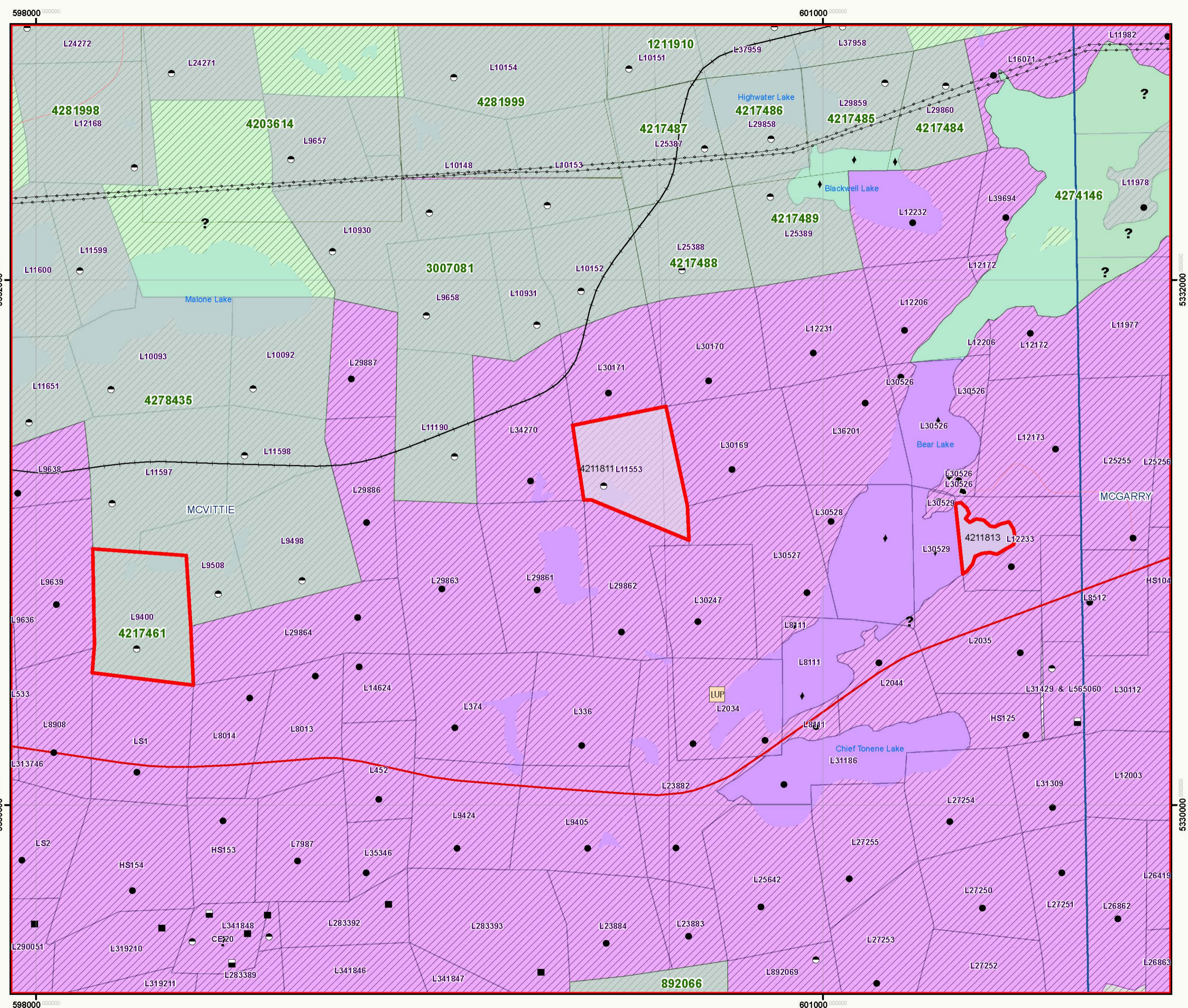

This map should not be relied on as a precise indicator of routes or locations, nor as a guide to navigation. The Ontario Ministry of Natural Resources (OMNR) shall not be liable in any way for the use of, or reliance upon, this map or any information on this map.

Il ne faut pas présumer que cette carte indique précisément les voies et les lieux, ni s'en servir comme guide à la navigation. Le ministère des Richesses naturelles de l'Ontario (MRN) n'assume aucune responsabilité quelle qu'elle soit relativement à l'utilisation de cette carte ou de la confiance qui serait mise en celle-ci.

© Queen's Printer for Ontario, <May 12, 2016>