

ORDER

SECTION 35, THE MINING ACT, R.S.O. 1990

ORDER NO. W-L-51/25

The SURFACE RIGHTS and MINING RIGHTS of the area outlined in red on the attached sketch, situated in the Township of Teck, Larder Lake Mining Division, containing 12.10 hectares more or less, are hereby WITHDRAWN from prospecting, mining claim registration, sale and lease.

This area is WITHDRAWN while the Ministry determines the status of the lands.

Saving, excepting and reserving hereto and herefrom, all other lands patented, sold, leased or otherwise alienated by the Crown at the date of this Order.

Any alienated lands lying within the limits of these withdrawn areas that revert to the Crown subsequent to the date of this Order will automatically be considered to be withdrawn as part of this Order.

This order comes into effect upon signing.



Date: April 8, 2025

James Schwyer, Provincial Mining Recorder
Mining Lands Section
Mines and Minerals Division

Time: 11:11 am

Copies:

Senior Manager, Mining Lands Section, MEM, Sudbury
Provincial Mining Recorder, MEM, Sudbury
Provincial Lands Specialist – CLR

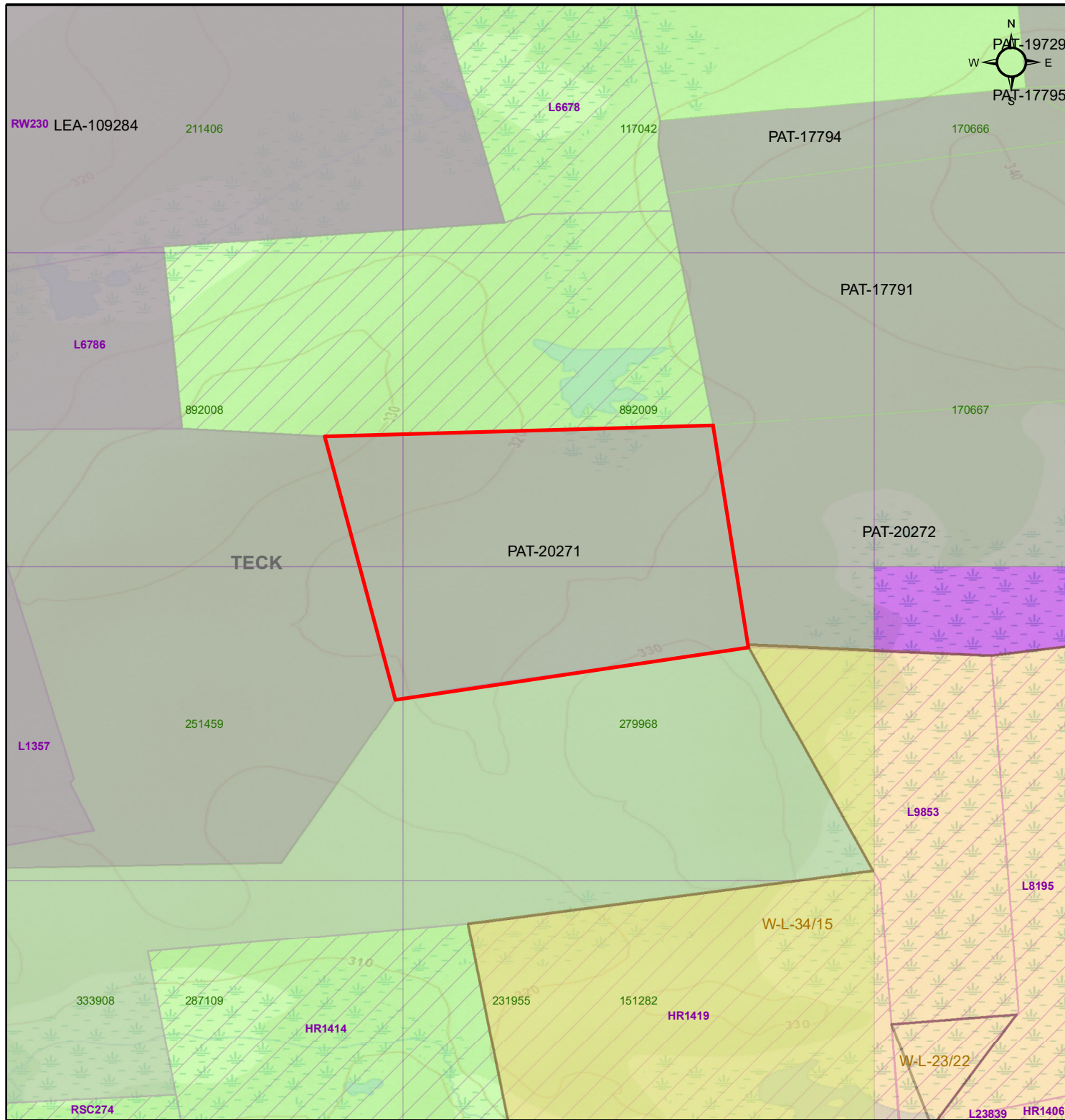

W-L-51/25

Teck Township
Larder Lake Mining Division



- Withdrawal
 - Notice
 - Order-in-Council
 - Cell Claims
- Land Tenure**
- Surface Rights
 - Mining Rights
 - Mining and Surface Rights

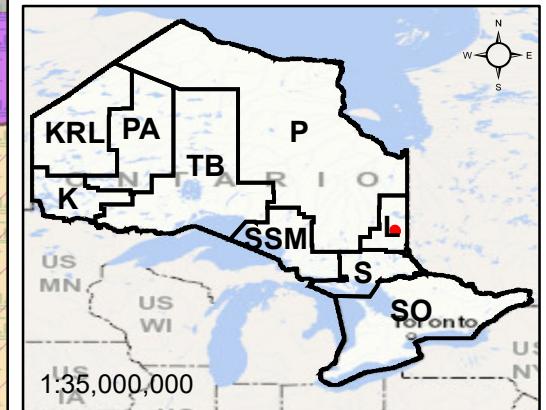

Scale: 1:8,000
Projection: CGS NAD 1983 (CSRS)

