

ORDER

SECTION 35, THE MINING ACT, R.S.O. 1990

ORDER NO. W-L-52/15

The MINING RIGHTS of the area outlined in red on the attached sketch, being cancelled mining claim L 4240521, situated in the Township of Guibord (G-3642), in the Larder Lake Mining Division, containing 128.0 hectares more or less, are hereby WITHDRAWN from prospecting, staking out, sale or lease.

This area is WITHDRAWN while the Ministry determines the status of the lands.

Saving, excepting and reserving hereto and herefrom, all other lands patented, sold, leased or otherwise alienated by the Crown at the date of this Order.

Any alienated lands lying within the limits of this withdrawn area that revert to the Crown subsequent to the date of this Order will automatically be considered to be withdrawn as part of this Order.

This order comes into effect upon signing.

Date: August 5 2015

Time: 4:42 pm

ORIGINAL SIGNED BY "TONY SCARR"

Tony Scarr, Provincial Mining Recorder

Mining Lands Section

Mines and Minerals Division

Copies:

Senior Manager, Mining Lands Section, MNDM, Sudbury

Provincial Mining Recorder, MNDM, Sudbury

Provincial Lands Specialist – CLR

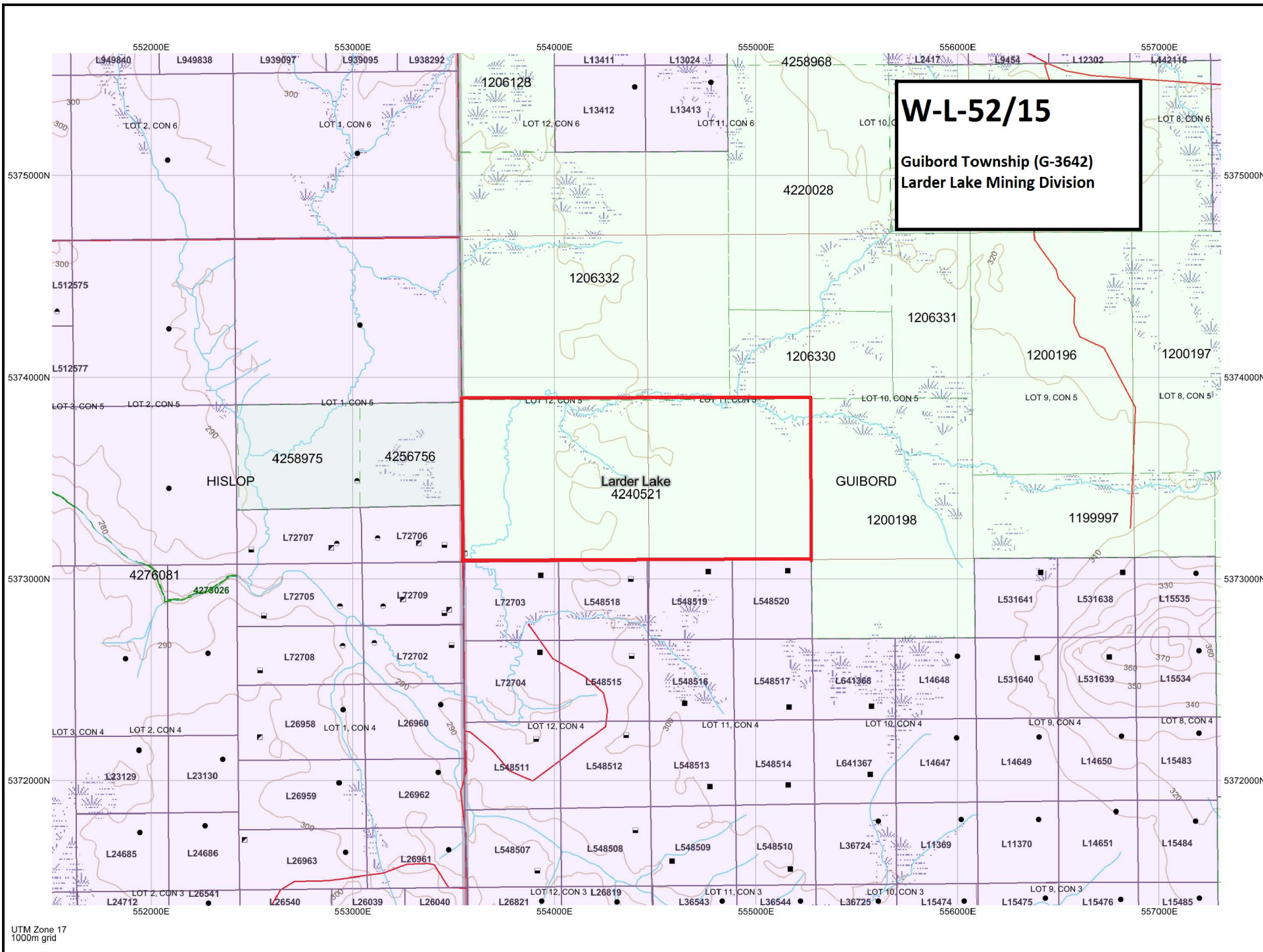

W-L-52/15
Guibord Township (G-3642)
Larder Lake Mining Division