

## ORDER

### SECTION 35, THE MINING ACT, R.S.O. 1990

#### ORDER NO. W-P-96/14

The SURFACE RIGHTS and MINING RIGHTS of the area outlined in red on the attached sketch, situated in the Township of Colquhoun, in the Porcupine Mining Division, containing 304 hectares more or less, are hereby WITHDRAWN from prospecting, staking out, sale or lease.

This area is WITHDRAWN for aggregate extraction for MTO construction projects.

Saving, excepting and reserving hereto and herefrom, all other lands patented, sold, leased or otherwise alienated by the Crown at the date of this Order.

Any alienated lands lying within the limits of this withdrawn area that revert to the Crown subsequent to the date of this Order will automatically be considered to be withdrawn as part of this Order.

This order comes into effect upon signing.

Date: January 5 2015

Time: 3:10 p.m.

ORIGINAL SIGNED BY "TONY SCARR"

Tony Scarr, Provincial Mining Recorder  
Mines and Minerals Division

Copies:

Senior Manager, Mining Lands Section, MNDM, Sudbury  
Provincial Mining Recorder, MNDM, Sudbury  
Provincial Lands Specialist – CLR

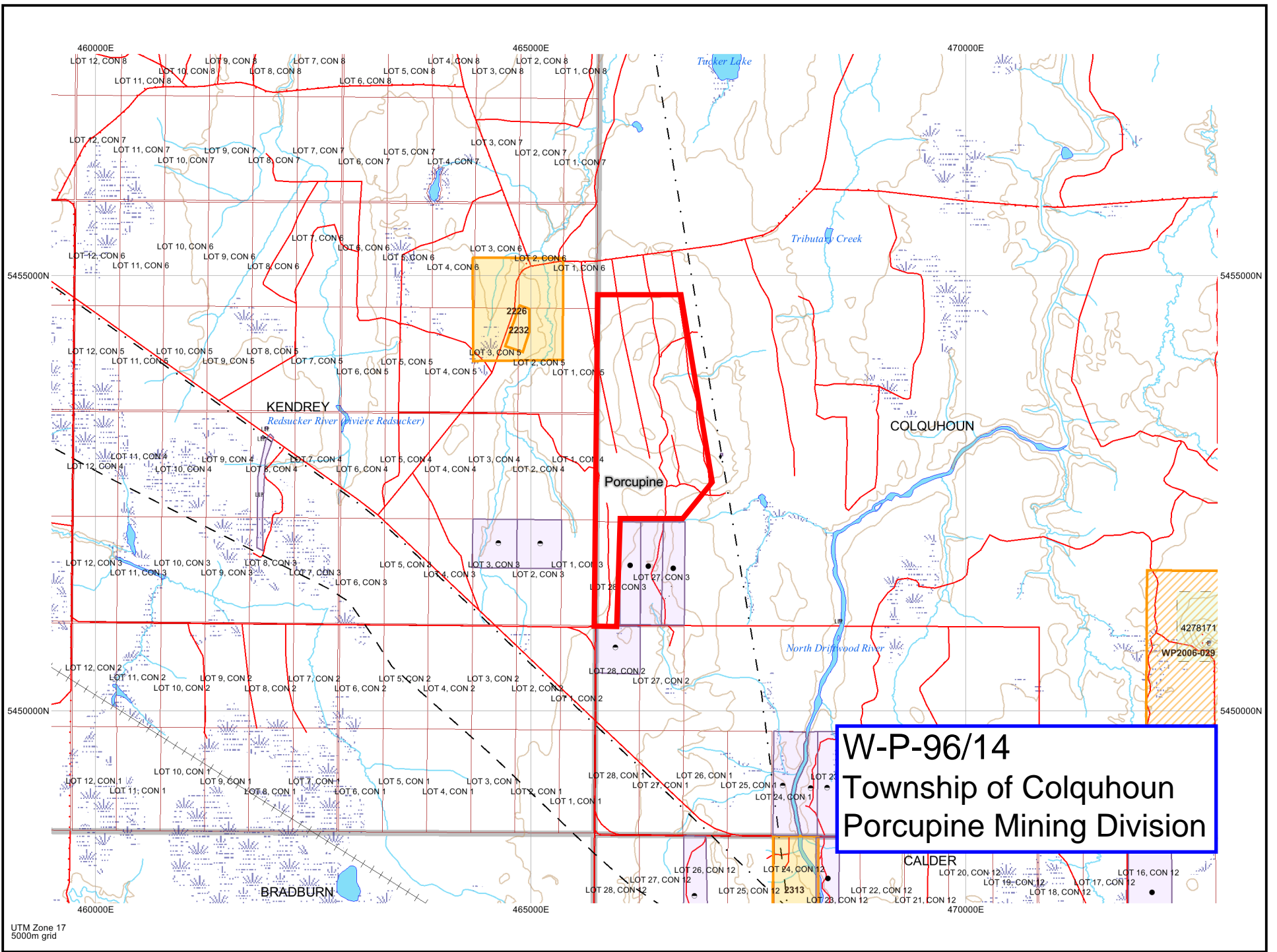

UTM Zone 17  
5000m grid