

ORDER

SECTION 35, THE MINING ACT, R.S.O. 1990

ORDER NO. W-PA-05/25

The SURFACE RIGHTS and MINING RIGHTS of the area outlined in red on the attached sketch, situated in the Township of Echo, Patricia Mining Division, containing 197.74 hectares more or less, are hereby WITHDRAWN from prospecting, mining claim registration, sale and lease.

This area is WITHDRAWN by the Ministry as the land is regulated as a wilderness area through the Wilderness Areas Act.

Saving, excepting and reserving hereto and herefrom, all other lands patented, sold, leased or otherwise alienated by the Crown at the date of this Order.

Any alienated lands lying within the limits of these withdrawn areas that revert to the Crown subsequent to the date of this Order will automatically be considered to be withdrawn as part of this Order.

This order comes into effect upon signing.

Date: January 24, 2025

Time: 5:07 pm



Afsana Qureshi, Assistant Deputy Minister
Mines and Minerals Division

Copies:

Senior Manager, Mining Lands Section, MINES, Sudbury

Provincial Mining Recorder, MINES, Sudbury

Provincial Lands Specialist – CLR

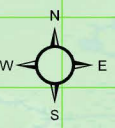
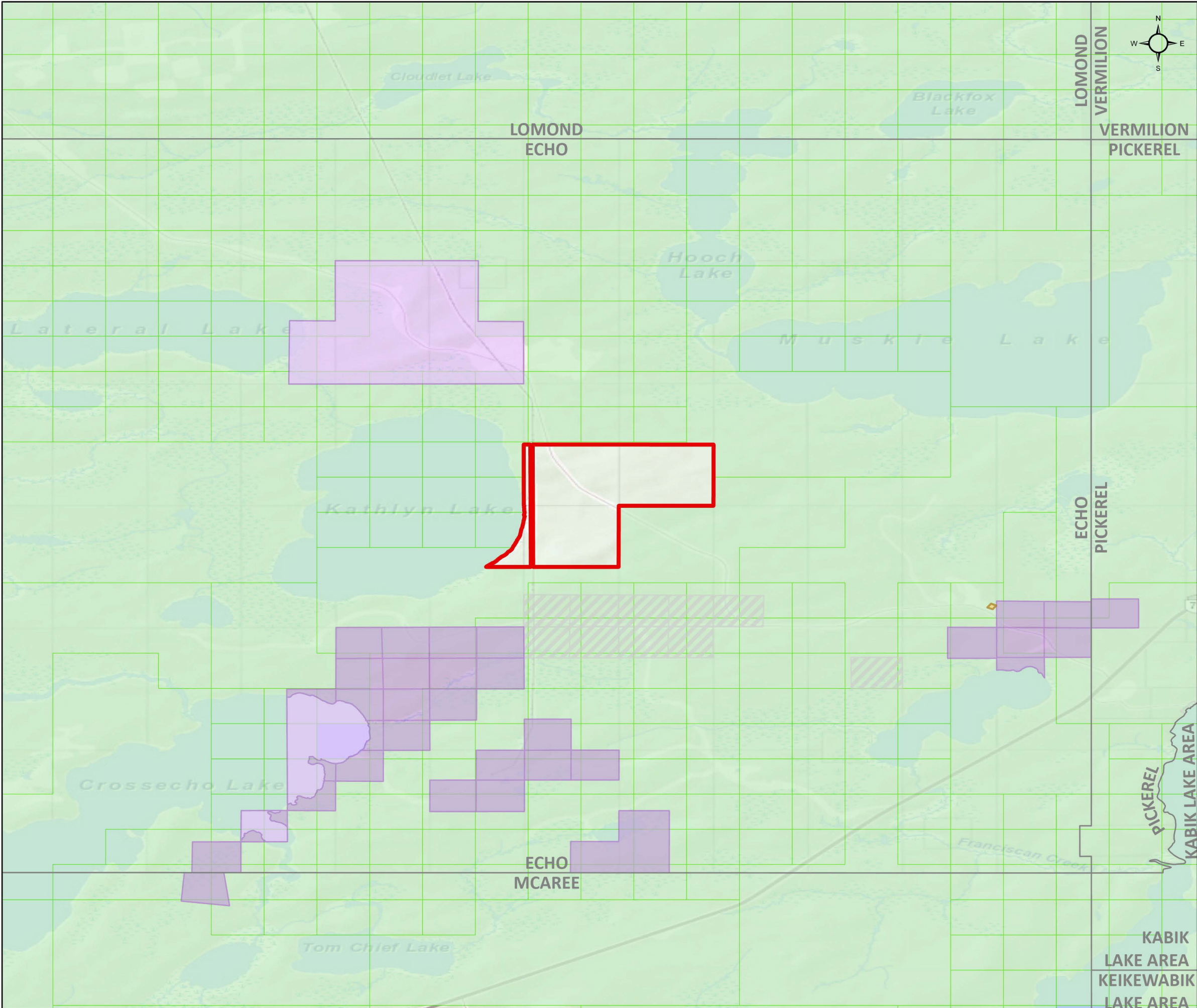

W-PA-05-25

Echo Township
Patricia Mining Division

 **Withdrawal Area**

-  Withdrawal (Mining Only, Mining & Surface)
-  Withdrawal (Surface Only)
-  Order-in-Council
-  Mining Claims
- Mining Land Tenure**
 -  Mining Land Tenure (Surface Only)
 -  Mining Land Tenure (Mining Only)
 -  Mining Land Tenure (Mining & Surface)
- Non-Mining Land Tenure**
 -  Non-Mining Land Tenure (Surface Only)
 -  Non-Mining Land Tenure (Mining & Surface)

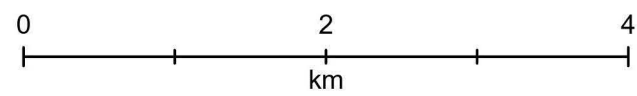
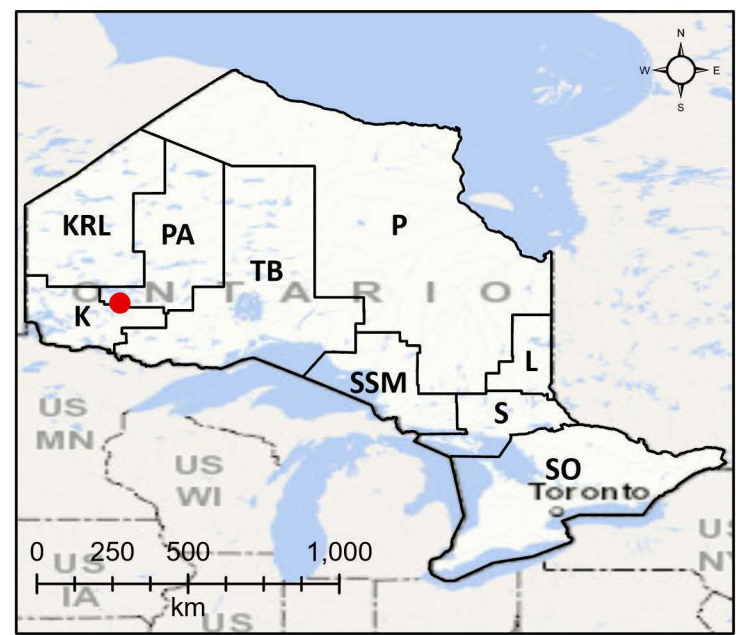

Scale: 1:50,000
Date: 2025-01-20
Projection: NAD 1983 CSRS



© King's Printer for Ontario, 2024