

ORDER**SECTION 35, THE MINING ACT, R.S.O. 1990****ORDER NO. W-SSM-40/17**

The SURFACE RIGHTS and MINING RIGHTS of the mining claims 4278195, 4278196 & 4278198, outlined in red on the attached sketch, situated in Vankoughnet Township (G-3058), in the Sault Ste. Marie Mining Division, containing 112 hectares more or less, are hereby WITHDRAWN from prospecting, staking out, sale or lease.

This area is WITHDRAWN as the Ministry determines the status of the lands.

Saving, excepting and reserving hereto and herefrom, all other lands patented, sold, leased or otherwise alienated by the Crown at the date of this Order.

Any alienated lands lying within the limits of this withdrawn area that revert to the Crown subsequent to the date of this Order will automatically be considered to be withdrawn as part of this Order.

This order comes into effect upon signing.

Date: JUL 24 2017

Time: 3:30 pm

ORIGINAL SIGNED BY PATRICK BROWN
Patrick Brown, A/Provincial Mining Recorder
Mines and Minerals Division

Copies:

Senior Manager, Mining Lands Section, MNDM, Sudbury

Provincial Mining Recorder, MNDM, Sudbury

Provincial Lands Specialist – CLR

W-SSM 40/17
Vankoughnet Township (G-3058)
Sault Ste. Marie Mining Division

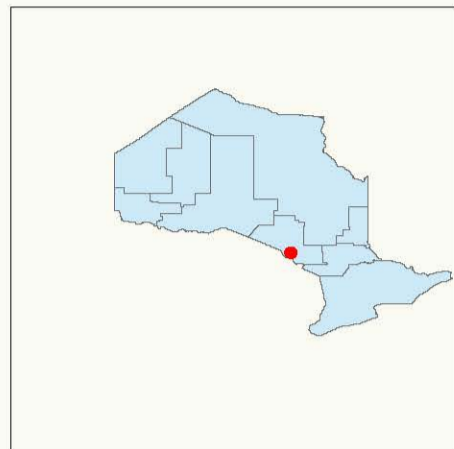

Base Features

- Area to be Withdrawn
- Tower
- Work Camp
- Utility Site
- MNDM Administrative Boundaries
- Lot Fabric Improved
- Utility Line - Hydro Line**
 - Transmission Line / Ligne de transmission
 - Pipeline / Pipeline
- Road Segment**
 - Other Existing Roads / Autres routes actuelles
 - Primary / Route principale
 - Highway / Autoroute
 - Trail Segment
 - Railway Segment
- Airports**
 - Airports
 - Airport Airstrip
 - Airport Official
- Federal Protected Area**
 - Federal Protected Area
 - Federal Land Other
 - Indian Reserve
- Waterbodies**
 - River / Stream
 - Waterbody
- Provincial Park Regulated**
 - Provincial Park Regulated
 - Conservation Reserve Regulated

Mining Lands Features

- Dispositions Symbols**
 - Freehold Patent, S+M
 - Freehold Patent, SRO
 - Freehold Patent, MRO
 - Leasehold Patent, S+M
 - Leasehold Patent, SRO
 - Leasehold Patent, MRO
 - Licence of Occupation, S+M
 - Licence of Occupation, SRO
 - Licence of Occupation, MRO
 - Licence of Occupation, not specified
 - Tower
 - Camp
 - Unknown
- OIC Order in Council
- LUP Land Use Permit
- WPLA WPLA
- MNDM Alienations**
 - Active, Withdrawal
 - Active, Notice
 - Cancelled, Withdrawal
 - Cancelled, Notice
- MNDM Mining Claims**
 - Active
 - Cancelled
 - Pending
- MNDM Dispositions**
 - Active
 - Cancelled

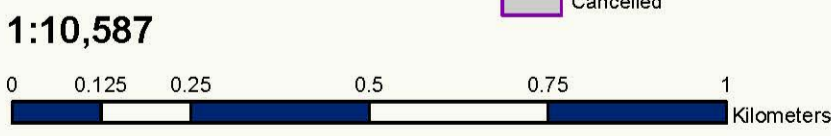
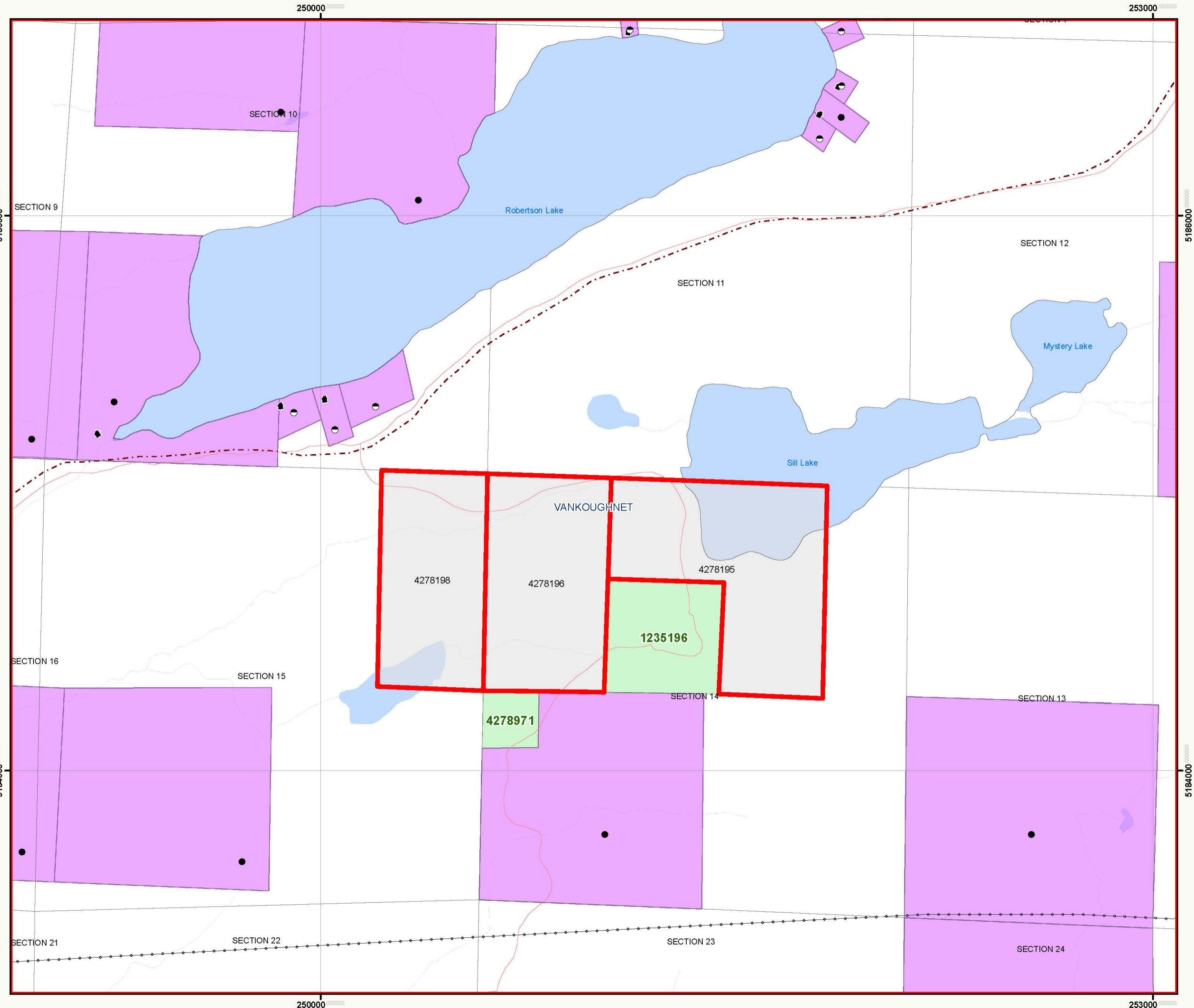

This map should not be relied on as a precise indicator of routes or locations, nor as a guide to navigation. The Ontario Ministry of Natural Resources (OMNR) shall not be liable in any way for the use of, or reliance upon, this map or any information on this map.

Il ne faut pas présumer que cette carte indique précisément les voies et les lieux, ni s'en servir comme guide à la navigation. Le ministère des Richesses naturelles de l'Ontario (MRN) n'assume aucune responsabilité quelle qu'elle soit relativement à l'utilisation de cette carte ou de la confiance qui serait mise en celle-ci.